



## Experience *quality* Affordable Living

Franklin Station Permanent Supportive Housing includes coordination of on-site property management and supportive services. The goal is to create a caring community that encourages individuals to reach their full potential in order to ensure housing success.

**Franklin Station**  
**524 W Broad Street**  
**Columbus, Ohio 43215** (see reverse)

**Rent:** Based on 30% of adjusted annual income

**Utilities:** Included

**Unit Type:** 1 Bedrooms

**Square Footage:** 647 - 793 sq. ft.

**Community Resources:** (See reverse)

**Qualifications:**

Designed to provide housing for adults with disabilities (including long-term illness, mental illness, and substance abuse), and individuals that are currently or have experienced homelessness.

**To apply:**

Applications must be submitted through an ADAMH or shelter Case Manager and processed by the Unified Supportive Housing System at the Community Shelter Board. For questions or referrals, contact the property office today.

**Property Office:**  
**Franklin Station**  
 524 W Broad Street  
 Columbus, OH 43215  
**Phone:** 614.662.1020 ext. 5001  
**TTY:** 800.750.0750  
**Visit us online:**  
[www.cpoms.org](http://www.cpoms.org)

**AMENITIES:**

- Fully Furnished Apartments
- Central Air
- Appliances Included
- Exercise Room
- Secured Building with Intercom
- Spacious Community Room
- Laundry Facilities
- Elevator
- Staffed 24-Hours
- On-Site Supportive Services
- Community Outreach Classroom and Training Center
- Computer and Resource Room
- Library/Lounge
- On-Site Wellness Center and Clinic
- On-Site Food Pantry
- Convenient to Downtown, dining and entertainment
- On COTA Busline



# Franklin Station:

Quality, affordable one-bedroom fully furnished apartment homes located in Franklinton, west of downtown Columbus. Call our property office today for details.

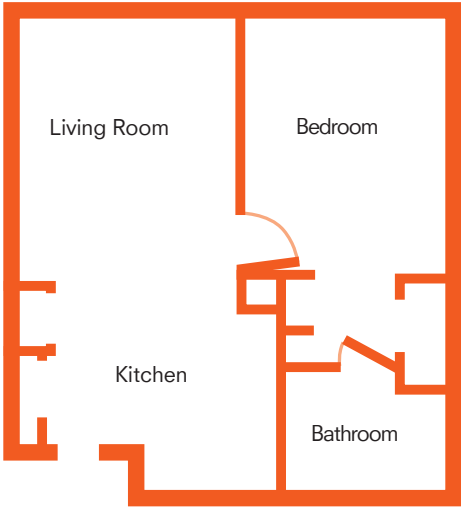

# Community Resources:

On-site service coordination assists residents with basic needs as well as supportive services including:

- Crises Intervention and Support Groups
- Conflict Resolution and Mediation
- Medical Clinic and Psychiatric Services
- Recovery Readiness Services (Alcohol & other Drug Addiction)
- Daily Living Skills Assistance
- Recreational/Socialization Opportunities
- Financial/Budgeting Support
- Transportation Services
- Choice Food Pantry



# Welcome home

Reliable management. Quality, affordable living.